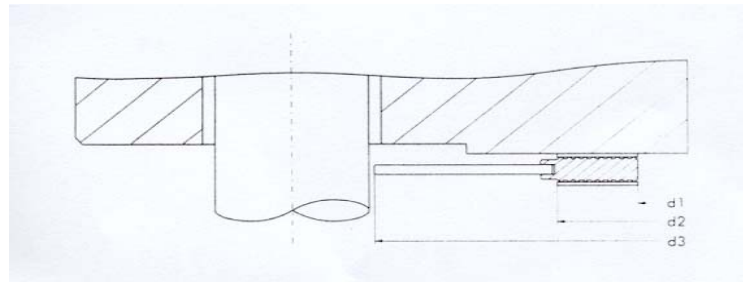

Table 78



Camprofile Gaskets for DIN flanges styles M18L and M20L according to DIN 2697

Nominal Pipe Dimensions (mm)	d 21 (mm)	d 2 (mm)	Number of Cams Z	d 3 (mm)					
				PN					
				64	100	160	250	320	400
10	22	40	6	56	56	56	67	67	67
15	25	45	7	61	61	61	72	72	77
25	36	68	11	82	82	82	82	92	103
40	50	88	13	102	102	102	108	118	135
50	62	102	13	112	118	118	123	133	150
65	74	122	16	137	143	143	153	170	192
80	90	138	16	147	153	153	170	190	207
100	115	162	16	173	180	180	202	229	256
125	142	188	15	210	217	217	242	274	301
150	165	218	18	247	257	257	284	311	348
175	190	260	23	277	287	284	316	358	-
200	214	285	24	309	324	324	358	398	442
250	264	345	27	364	391	388	442	488	-
300	310	410	33	424	458	458	-	-	-
350	340	465	39	486	512	-	-	-	-
400	386	535	50	543	-	-	-	-	-

Tolerances in millimetres:

DN (mm)		DN (inch)		d 1	D 2	d 3
15	200	1/2	8	+ / - 0.4	+ / - 0.8	+ / - 0.8
250	600	10	24	+ / - 0.8	+ 1.5 - 0.8	+ / - 0.8
650	850	26	34	+ / - 0.8	+ / - 1.5	+ / - 0.8
900	1500	36	60	+ / - 1.25	+ / - 1.5	+ / - 0.8

Camprofile Thickness = 4.00 + 0 / - 0.25mm or 3.00mm + 0 / - 0.25mm

Note:

Novus Sealing Camprofiles to DIN 2697 are supplied with a standard cam pitch of 1.5mm.